

310440-SM-CC-EC-VV

ITEM NO.	PART NUMBER	DESCRIPTION	QTY.
1	01-0184	WASHER LOCK 1/2 REGULAR BLOX	8
2	01-0229	NUT HEX REGULAR 1/2 - 13 ZINC	8
3	01-2007	SCR., HHC 1/2-13 X 1.75 ZN PL	8
4	01-2023-2	SCREW, RIVET, #2 X .188, SS	2
5	03-1179	BODY, P/P SOL. ADAPTOR	1
6	03-1180	EXHAUST ADAPTOR	1
7	03-4001	NAMEPLATE, SERIES 20 SOL. OPP.	1
8	04-01-010	O-RING, BUNA 70, #010	1
9	20-1726	BODY 2, 2 1/2 NPT	1
10	20-1890	NAME PLATE, 1 1/4 - 2 1/2 NPT, T-O-M	1
11	SEE TBL (EC)	END CAP 2 1/2"	2
12	SEE TBL (SM)	SLEEVE	1
13	SEE TBL (VV)	SOLENOID ASSY	1
14	SEE TBL (CC)	CENTER CORE ASSY	1

NOTES:

1. PILOT PRESSURE TO MEDIA PRESSURE RATIO: 1:1.
2. OPERATING PRESSURE: 150 PSI MAX.
3. TEMPERATURE RANGE: -30° F TO 225° F.
4. PRIMARY OPERATOR: DIRECT SOLENOID OPERATOR
5. SERVICE MEDIA: LIQUIDS AND INERT GASES.
6. SLEEVE MATERIAL: SEE SLEEVE MAT. OPTIONS (SM)
FOR ALL OTHERS CONSULT THE FACTORY.
7. SOLENOID VOLTAGE: AC OR DC.
8. FOR MAXIMUM SLEEVE LIFE, THE PILOT TO MEDIA PRESSURE DIFFERENTIAL, SHOULD NOT EXCEED 20 PSI. FOR MEDIA PRESSURE BELOW 50 PSI, THE PILOT PRESSURE IS MEDIA PRESSURE PLUS 15 PSI.

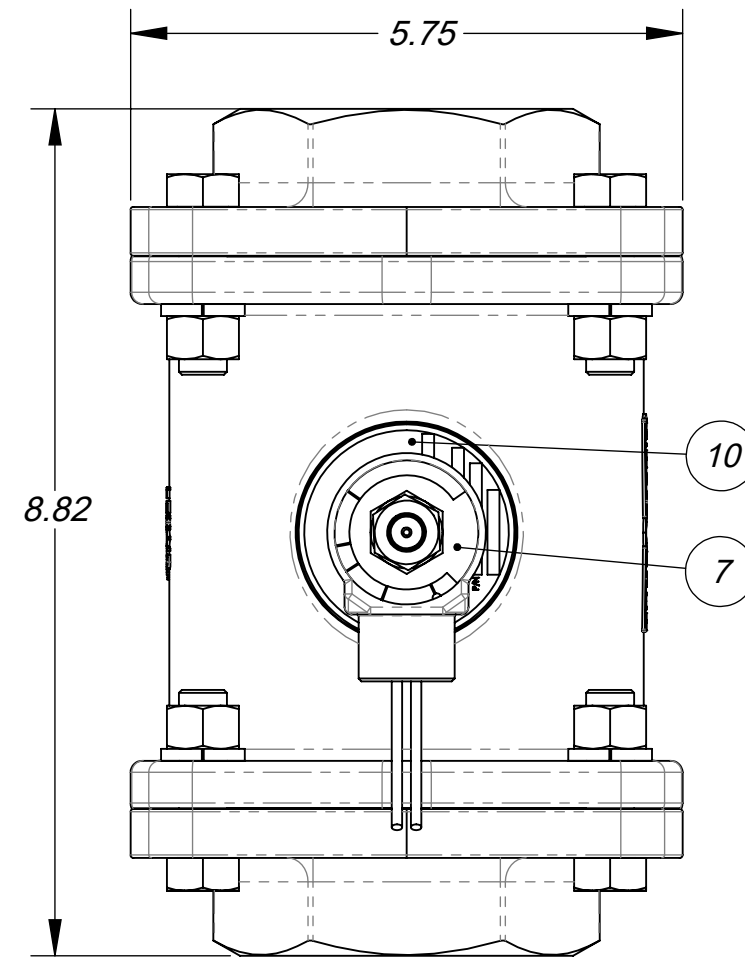

SLEEVE MATERIAL OPTIONS (SM)

CODE	MATERIAL	PART NO.
STD	BUNA - N	20-1395
26	VITON	20-1396
29	EPR	20-1397

CENTER CORE OPTIONS (CC)

CODE	MATERIAL	PART NO.
STD	NI PLTD AL	20-1070

END CAP OPTIONS (EC)

CODE	MATERIAL	PART NO.
STD	NI PLT BRNZE	20-1467

SOLENOID OPTIONS (VV)

CODE	VOLTAGE	PART NO.
-1	120V/60Hz	03-3701
-2	240V/60Hz	03-3702
-3	480V/60Hz	03-3703
-4	6V DC	03-3704
-5	12V DC	03-3705
-6	24V DC	03-3706
-7	24V/60Hz	03-3707

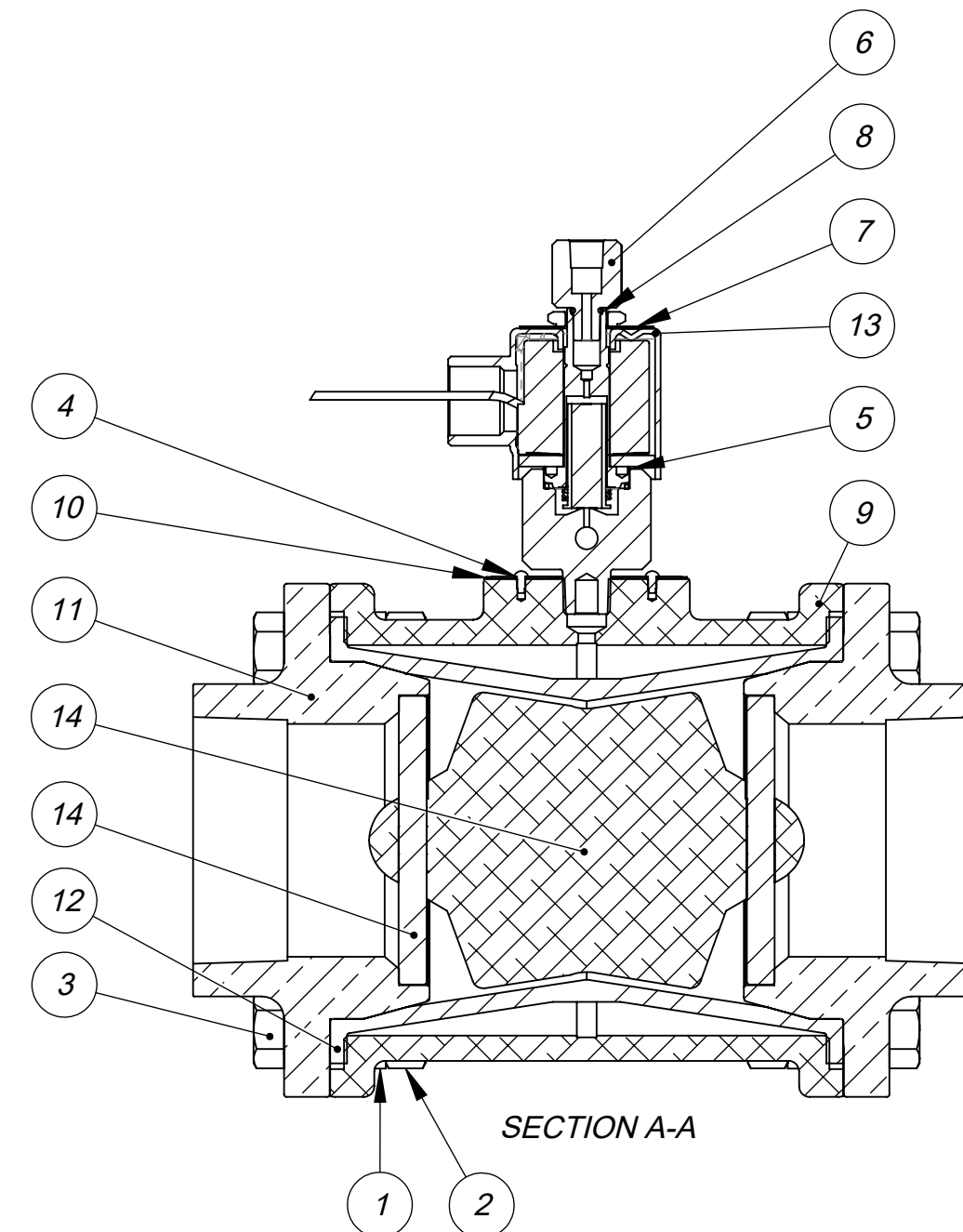
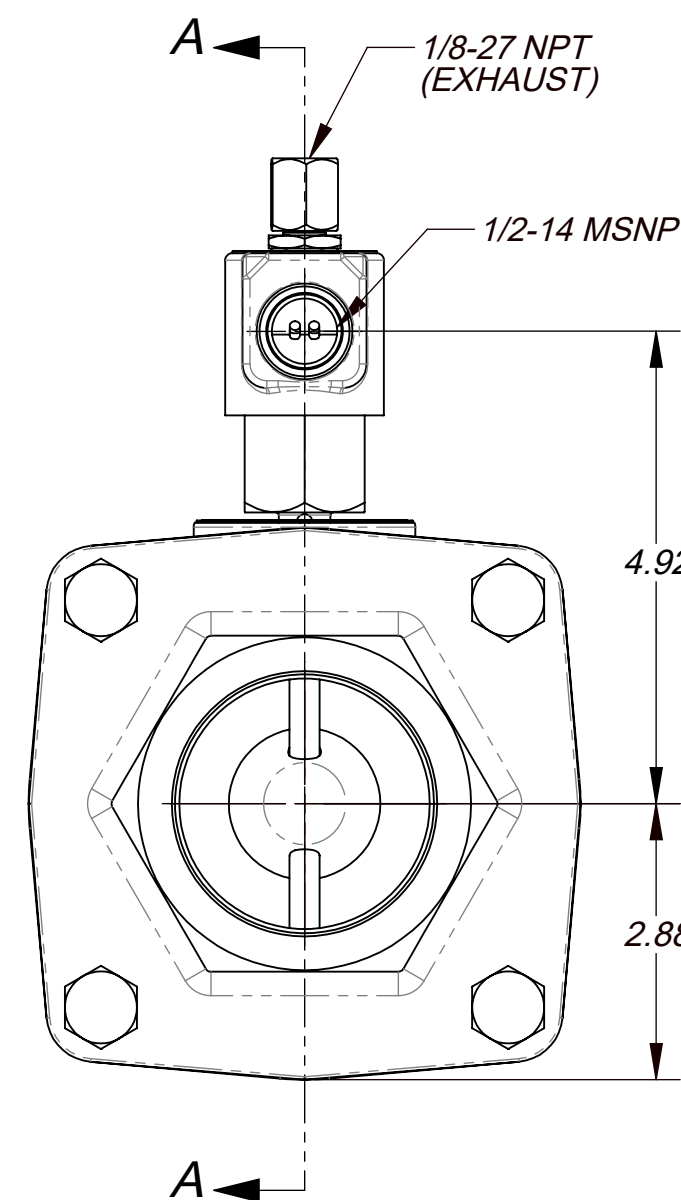
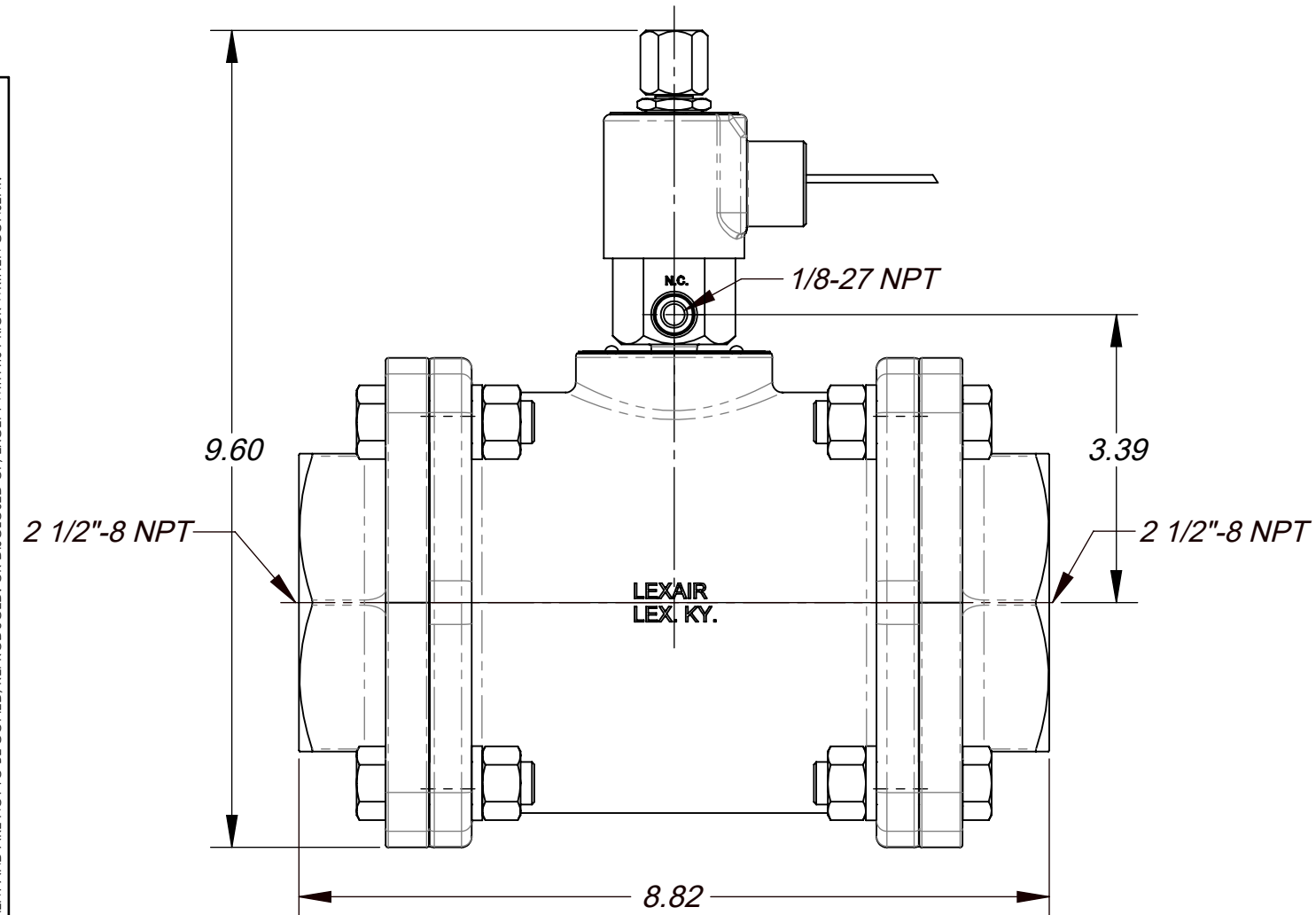

THIS DOCUMENT AND ITS CONTENTS ARE THE PROPERTY OF LEXAIR, INC. THEY ARE FURNISHED TO YOU ON THE FOLLOWING CONDITIONS: NO RIGHT OR LICENSE IN RESPECT OF THIS DOCUMENT OR ITS CONTENTS, EITHER OR WAIVED IN SUPPLYING THE DOCUMENT TO YOU. THIS DOCUMENT OR ITS CONTENTS ARE NOT TO BE USED IN ANY MANNER INCONSISTENT WITH THE RIGHTS OF LEXAIR, INC. OR TO ITS DETRIMENT AND ARE NOT TO BE COPIED, REPRODUCED, OR DISCLOSED OF, EXCEPT WITH ITS PRIOR WRITTEN CONSENT.

REVISIONS

- PREVIOUS REVS. OMITTED.
- B REDRAWN TO CURRENT ENG. STDS. ECL: 06113 10-16-06 HWP TPO
 - C REDRAWN TO CURRENT ENG. STDS. ECL: 21032 06-22-21 TES

ECL: 06113	Tolerances Unless Otherwise Specified:		MATERIAL SPEC.	PC. NO.: 310440-X
	TYPE	FINISHED	AS CAST	SEE TABLE
	DEC .00	± .015"	± .030"	PROCESS SPEC.
	DEC .000	± .005"	± .010"	SEE TABLE
FRACTIONAL		± 1/64"	± 1/32"	MODEL FILE: 310440.SLDASM
ANGLES *		± 1/2°	± 1°	CAD FILE: 310440.slddrw
FINISH 175 µ in.		C 310440		
SO, T-O-M, 2 1/2" NPT				
Lexair, Inc.		DRAWN	CHECKED	APRVD.
2025 Mercer RD, Lexington, Kentucky 40511		HWP	HWP	HWP
		10-16-06	10-16-06	10-16-06
		SHEET NO. 1 of 1		SHEETS
		SCALE 1:2		
		APPROX. WT. 23.941 lbs.		